

DETOUR

DUE TO CONSTRUCTION CORRIDOR CLOSED

TUESDAY 9/23 -WEDNESDAY 12/31

SEEK ALTERNATE ROUTE

In the event of an emergency, occupants will be able to access corridor
Thank you for your cooperation. MIT Department of Facilities

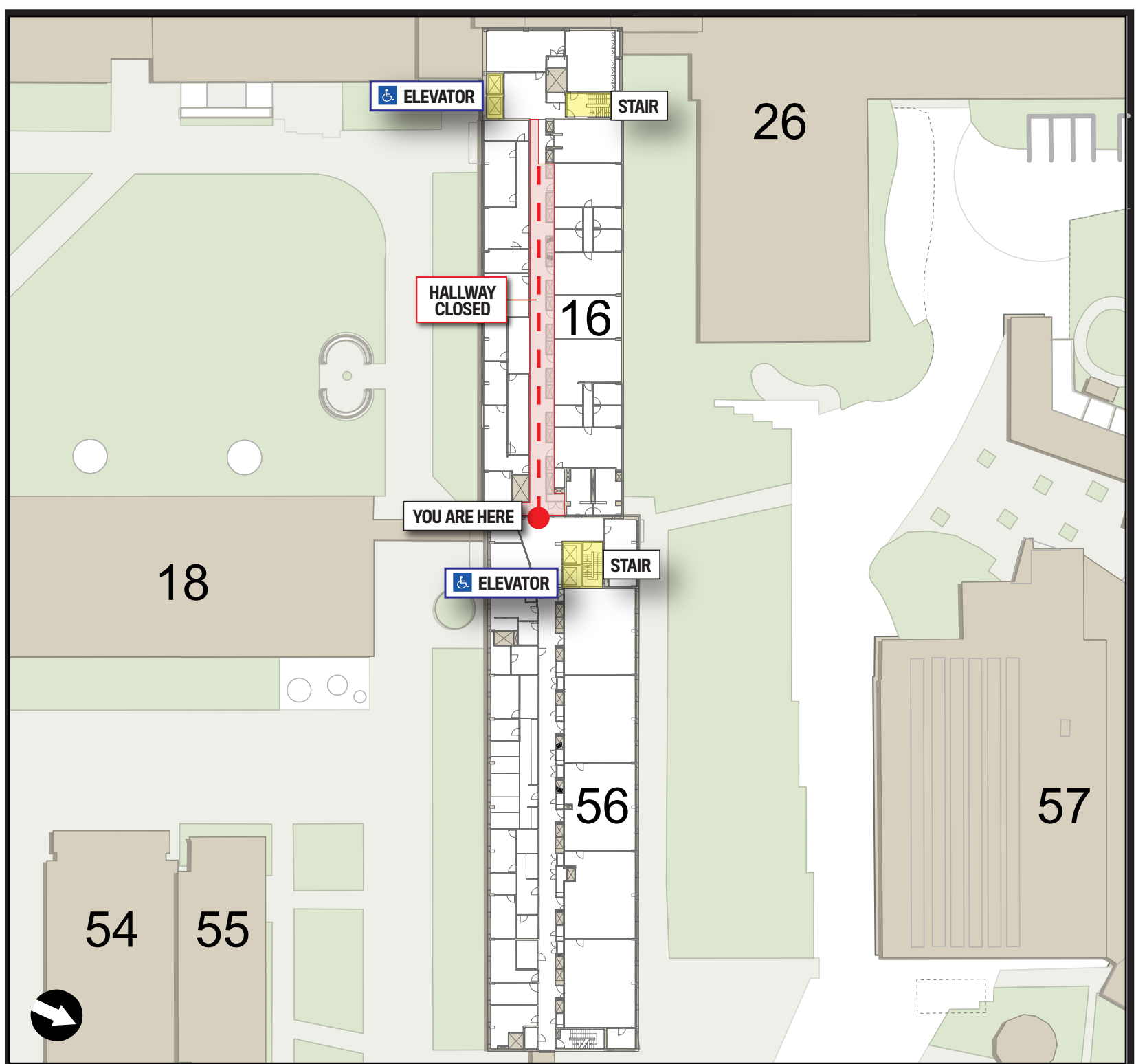

Questions about this work may be directed to

MIT Project Manager: Gianna Chisholm (salvaggi@mit.edu, 857-500-7004)

Santiago Hernandez (shjr@mit.edu, 617-851-4551)

Elaine Construction Site Superintendent:

Andrew Sinclair (ASinclair@elaine.com, 551-206-7058)

DETOUR

DUE TO CONSTRUCTION CORRIDOR CLOSED

TUESDAY 9/23 -WEDNESDAY 12/31

SEEK ALTERNATE ROUTE

In the event of an emergency, occupants will be able to access corridor
Thank you for your cooperation. MIT Department of Facilities

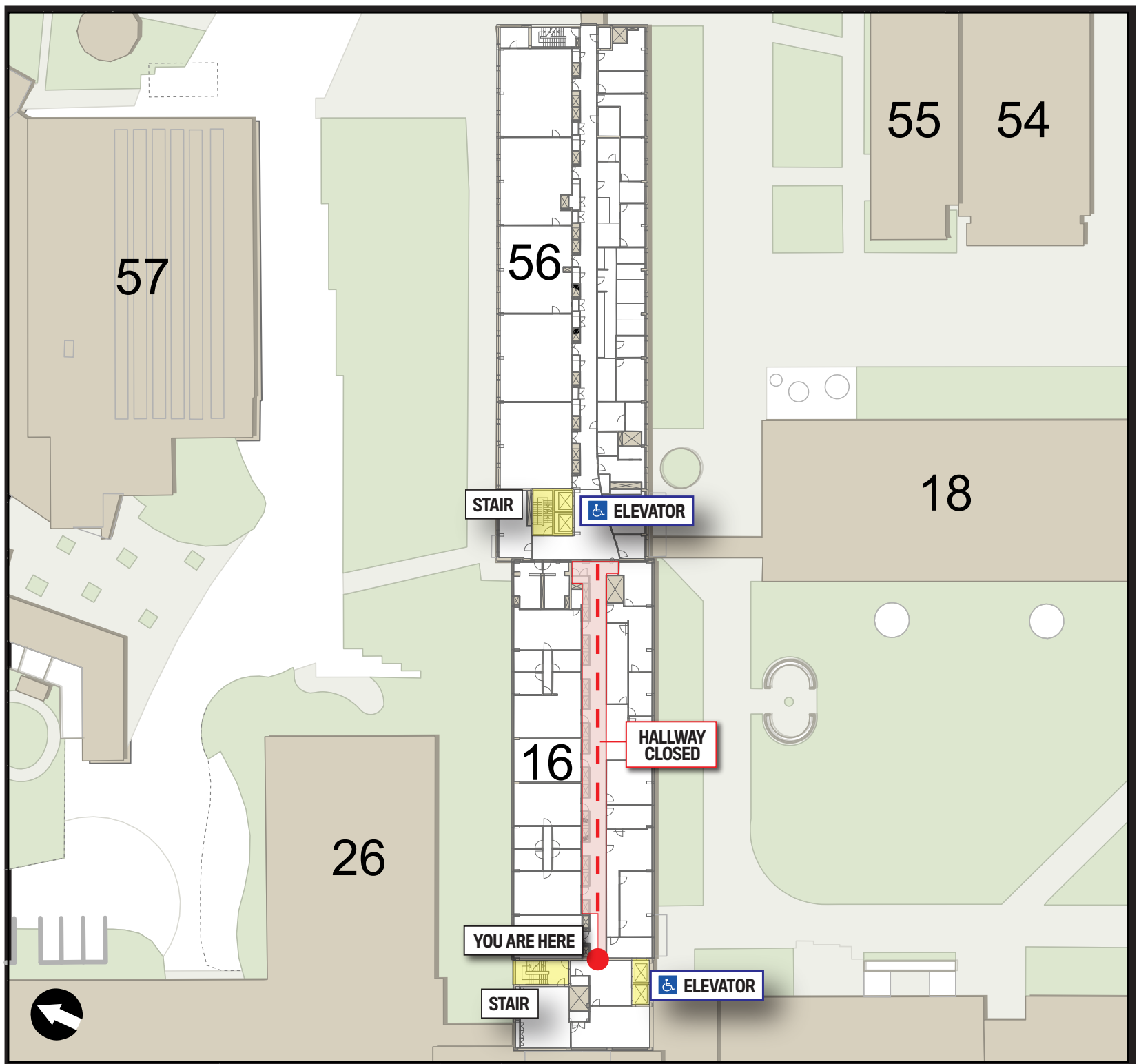

Questions about this work may be directed to

MIT Project Manager: Gianna Chisholm (salvaggi@mit.edu, 857-500-7004)

Santiago Hernandez (shjr@mit.edu, 617-851-4551)

Elaine Construction Site Superintendent:

Andrew Sinclair (ASinclair@elaine.com, 551-206-7058)